

Low series inductance and resistance - High peak & rms currents
Faibles résistance et inductance séries - Courant crête & efficace élevés

**Protection & switching assistance
for semi-conductors**
*Protection & aide à la commutation
des semi-conducteurs*

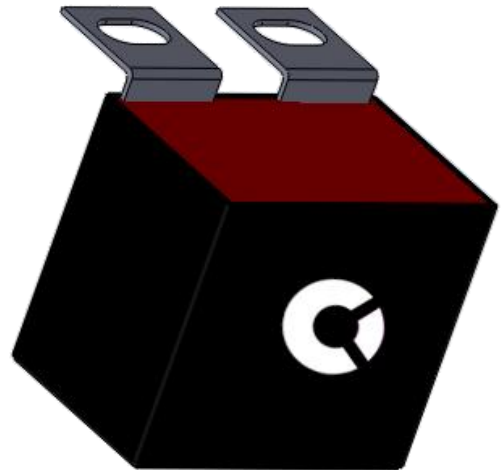

Dielectric - Diélectrique
 Metallized polypropylene - Polypropylène métallisé

Housing - Boîtier
 Non flammable plastic box (UL 94 V0)
 Parallélépipédique en plastique auto extinguable (UL 94 V0)

Sealing - Obturation
 Polyurethane resin - Résine polyuréthane

Terminals - Sorties:
 Tin plated brass lugs - Cosses laiton étamé

Tolerance - Tolérance
 ± 5 (± 2 on demand) - ± 5 (± 2 sur demande)

Operating temperature - Température d'utilisation
 -25° to +85°C - -25°C à +85°C

Test voltage between terminals
Tension d'essai entre bornes
 1.5 U_r [10 seconds] - 1.5 U_r [10 secondes]

Loss factor at 1 kHz - Tg δ maximum à 1 kHz
 Max 4.10⁻⁴

ESL — Inductance série
 Max 40 nH

Standard - Normes
 IEC 61071 - CEI 61071

Design 1

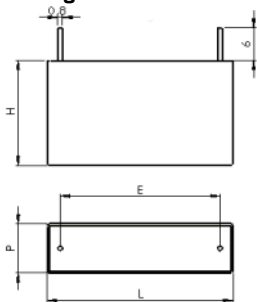

Design 2

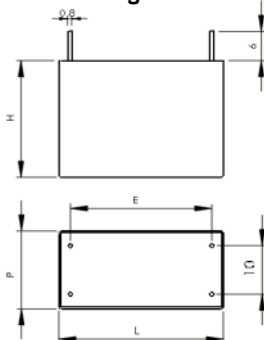

Design 3

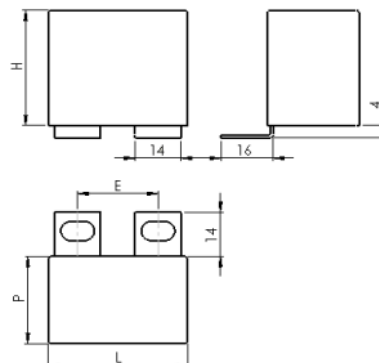

Part number <i>Code article</i>	Capacitance <i>Capacité</i> (μ F)	DC Voltage <i>Tension DC</i>	L (mm)	P (mm)	H (mm)	E (mm)	I_{rms} <i>I_{crité}</i> (A)	I_{peak} <i>I_{crité}</i> (A)	dV/dt V/ μ s	Design	
PAS220NBPPFR	0.22	700 V dc	32	9	19	27.5	1.30	193	875	1	
PAS330NBPPFR	0.33		32	9	19	27.5	1.85	280	846	1	
PAS470NBPPFR2	0.47		32	16	24	27.5	2.55	385	820	2	
PAS680NBPPFR2	0.68		32	16	24	27.5	3.61	542	797	2	
PAS1UBPPFR2	1		32	16	24	27.5	5.20	777	777	2	
PAS1U5BPPCS	1.5		42	17	27	37.5	5	750	500	3	
PAS2UBPPCS	2		42	17	27	37.5	6.55	980	490	3	
PAS2U2BPPCS	2.2		42.5	22	30	37.5	7.15	1070	485	3	
PAS3UBPPCS	3		42.5	28	37	37.5	9.60	1430	479	3	
PAS3U3BPPCS	3.3		42.5	28	37	37.5	10.50	1572	476	3	
PAS4UBPPCS	4		42.5	28	37	37.5	12.60	1887	472	3	
PAS4U7BPPCS	4.7		42.5	28	37	37.5	14.65	2197	467	3	
PAS6UBPPCS	6		42.5	30	45	37.5	18.50	2774	462	3	
PAS7UBPPCS	7		57	38	54	52.5	14.55	2185	312	3	
PAS8UBPPCS	8		57	38	54	52.5	16.55	2480	310	3	
PAS9UBPPCS	9		57	38	54	52.5	18.50	2774	308	3	
PAS10UBPPCS	10		57	38	54	52.5	20.50	3069	307	3	
PBS220NBPPFR	0.22	850 V dc	32	9	19	27.5	1.90	284	1293	1	
PBS330NBPPFR2	0.33		32	16	24	27.5	2.75	414	1253	2	
PBS470NBPPFR2	0.47		32	16	24	27.5	3.85	576	1226	2	
PBS560NBPPFR2	0.56		32	16	24	27.5	4.50	678	1210	2	
PBS680NBPPCS	0.68		42	17	27	37.5	3.25	487	716	3	
PBS820NBPPCS	0.82		42	17	27	37.5	3.85	580	707	3	
PB1UBPPCS	1		42	17	27	37.5	4.65	697	697	3	
PBS1U5BPPCS	1.5		42.5	22	30	37.5	6.80	10.20	680	3	
PBS2U2BPPCS	2.2		42.5	28	37	37.5	9.75	1463	665	3	
PBS2U5BPPCS	2.5		42.5	28	37	37.5	11	1650	660	3	
PBS3UBPPCS	3		42.5	30	45	37.5	13.10	1964	655	3	
PBS3U3BPPCS	3.3		42.5	30	45	37.5	14.35	2154	653	3	
PBS4UBPPCS	4		57	38	54	52.5	12.45	1865	466	3	
PBS4U7BPPCS	4.7		57	38	54	52.5	14.45	2167	461	3	
PBS6UBPPCS	6		57	38	54	52.5	18.10	2720	453	3	
PBS7UBPPCS	7		57	38	54	52.5	20.95	3140	449	3	
PBS8UBPPCS	8		57	38	54	52.5	23.75	3560	445	3	
PES100NBPPFR	0.1	1250 V dc	32	9	19	27.5	1.20	180	1795	1	
PES220NBPPFR2	0.22		32	16	24	27.5	2.50	373	1696	2	
PES330NBPPFR2	0.33		32	16	24	27.5	3.60	540	1640	2	
PES470NBPPCS	0.47		42	17	27	37.5	3.35	500	1064	3	
PES560NBPPCS	0.56		42	17	27	37.5	3.90	585	1045	3	
PES680NBPPCS	0.68		42.5	22	30	37.5	4.70	705	1035	3	
PES820NBPPCS	0.82		42.5	22	30	37.5	5.55	835	1020	3	
PES1UBPPCS	1		42.5	28	37	37.5	6.70	1000	1000	3	
PES1U5BPPCS	1.5		42.5	28	37	37.5	9.75	1460	970	3	
PES2U2BPPCS	2.2		57	38	54	52.5	10	1500	682	3	
PES2U5BPPCS	2.5		57	38	54	52.5	11.25	1685	675	3	
PES3UBPPCS	3		57	38	54	52.5	13.35	2000	667	3	
PES3U3BPPCS	3.3		57	38	54	52.5	14.60	2190	665	3	
PES4UBPPCS	4		57	38	54	52.5	17.50	2620	655	3	
PES4U7BPPCS	4.7		57	38	54	52.5	20.35	3055	650	3	
PQS47NBPPCS	0.047		2500 V dc	42	17	27	37.5	0.75	116	2470	3
PQS68NBPPCS	0.068			42	17	27	37.5	1.10	165	2430	3
PQS100NBPPCS	0.1	42		17	27	37.5	1.55	235	2350	3	
PQS150NBPPCS	0.15	42		17	27	37.5	2.30	344	2290	3	
PQS220NBPPCS	0.22	42.5		22	30	37.5	3.25	490	2230	3	
PQS330NBPPCS	0.33	42.5		28	37	37.5	4.75	716	2168	3	
PQS470NBPPCS	0.47	42.5		30	45	37.5	6.65	995	2117	3	
PQS560NBPPCS	0.56	42.5		30	45	37.5	7.80	1170	2090	3	
PQS680NBPPCS	0.68	57		38	54	52.5	6.25	940	1380	3	
PQS820NBPPCS	0.82	57		38	54	52.5	7.45	1120	1365	3	
PQS1UBPPCS	1	57		38	54	52.5	9	1350	1350	3	
PQS1U5BPPCS	1.5	57		38	54	52.5	13	1980	1320	3	

SCR
 + 33 2 54 22 27 24

 info@scr.fr

Head office: ZI la Malterie - 36130 Montierchaume - France

www.cefem-group.com